

AVENIO Designer Software

*Code-free protocol configuration for automated
NGS sample prep on the AVENIO Edge System*





AVENIO Designer Software

Makes code-free protocol configuration possible

The AVENIO Designer Software is a cloud-based solution that enables laboratory personnel to rapidly customize, convert and modify protocol templates for laboratory-defined research workflows on the AVENIO Edge System. The AVENIO Designer Software templates allow the user to rapidly and easily deploy automated Library Preparation, Quantification, and Target Enrichment and pooling protocols onto the AVENIO Edge System.



The AVENIO Designer Software empowers lab personnel to transfer the same research workflow across multiple instruments, change a workflow without need for programming, stop and start at various steps (in the workflow) and configure workflows from any internet browser in or outside the lab.

- Easy-to-use interface with tunable parameters
- Unparalleled flexibility allows changing workflows at any time
- Validated workflows are pre-populated with recommended parameters and the ability to adjust if needed
- Easily deploy protocols, assess the performance and fine tune until satisfied with the results

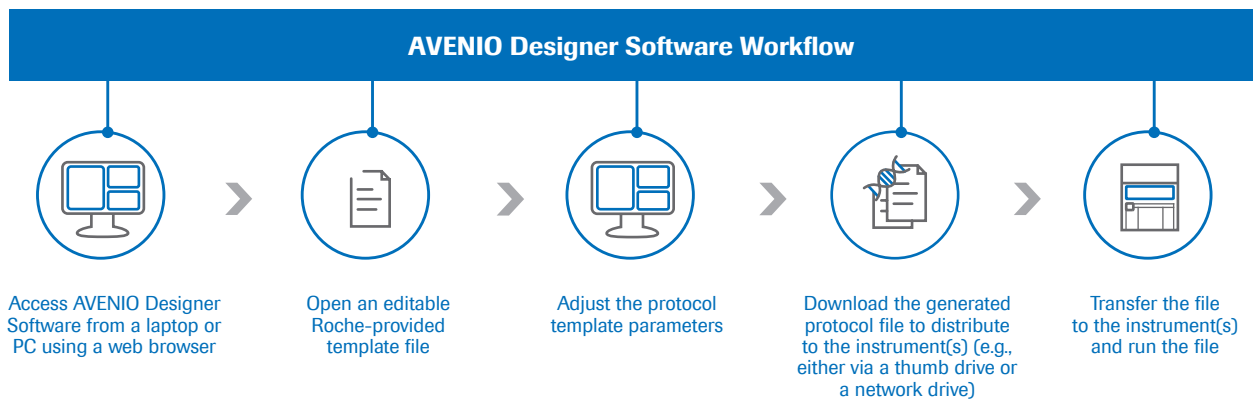



AVENIO Designer Software

Ready-to-use customizable templates

Labs can choose from a set of predefined run research protocols that fit their throughput, lab setup and operations. They can define starting and stopping points for their protocols and include or exclude specific steps. The following templates are available:

- Input Control (8 - 96 samples)
- Library Preparation (8 - 48 samples)
- Target Enrichment (8 - 48 samples)
- Pre-capture pooling and target enrichment (48 samples)
- Pooling (8 - 48 samples)
- Library Preparation and Target Enrichment (24 samples)
- Library Preparation and Target Enrichment (8 - 16 samples)

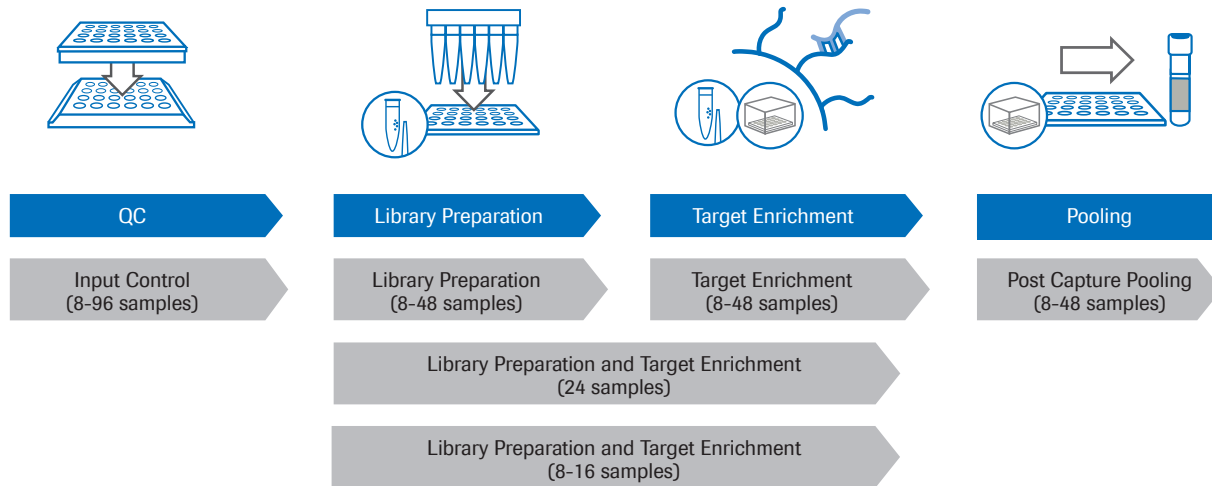

Fine tune and optimize protocols

The AVENIO Designer Software can be accessed from any web browser inside or outside of the laboratory. Labs can either rely upon the default, pre-validated settings of the selected protocols or change important parameters in the protocol to optimize the performance for their specific application. They can download the protocol to deploy on their AVENIO Edge Systems, evaluate the performance and change parameters for optimization. When satisfied with the results, the protocol can be validated and version controlled.



Published by:
Roche Sequencing and Life Science
9115 Hague Road
Indianapolis, IN 46256

sequencing.roche.com

User-defined protocols created using AVENIO Designer Software are for Research Use Only (RUO) workflows, not for use in diagnostic procedures.
The AVENIO Edge System, reagents and workflows are for Research Use Only. They are not intended for diagnostic procedures.
AVENIO and AVENIO EDGE are trademarks of Roche.
All other product names and trademarks are the property of their respective owners.
©2023 Roche Sequencing Solutions. All rights reserved.